

Current Transformers

Window Diameter: 1.7"
Continuous Thermal Rating: 1.33 at 30 C. amb.;
1.0 at 55 C. amb. Average.

Application: Ammeters and Wattmeters and Relays.
Insulation Class: 0.6 kV. BIL 10kV. full wave 50-400 Hz.
Fully encapsulated.

Standard 5 amp secondary, others available.

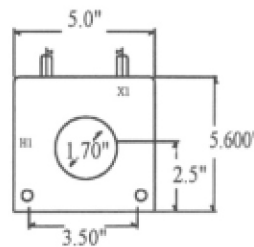
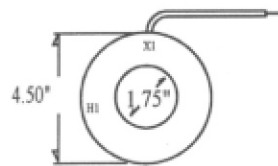
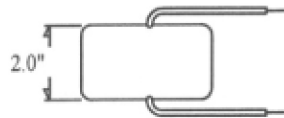

17502RW

17502SH

Model nbr.

17502RW
17502SH

To order, please complete the model number with the appropriate suffix.
eg. 17502RW-100

Catalogue nbr. Suffix	Current Ratio	Relay Class	ANSI Metering Class @ 60Hz				
			BO.1	BO.2	BO.5	BO.9	B1.8
-100	100:5	-	0.6	1.2	2.4	4.8	-
-150	150:5	C10	0.3	0.6	1.2	2.4	4.8
-200	200:5	C10	0.3	0.6	0.6	1.2	2.4
-250	250:5	C20	0.3	0.3	0.6	0.6	1.2
-300	300:5	C20	0.3	0.3	0.3	0.6	1.2
-400	400:5	C20	0.3	0.3	0.3	0.6	0.6
-500	500:5	C20	0.3	0.3	0.3	0.3	0.6

- ▶ Flexible leads are UL 3173 125 degree C.
- ▶ CSA approved, # 16 AWG 24" long. Nonstandard length to be specified.
- ▶ Terminals are brass No. 10-32 UNC.
- ▶ Optional mounting bracket 2547MBK.
- ▶ Approximate weight 5.0 lb.
- ▶ Additional ratios available.

Current Transformers

Window Diameter: 1.7"
Continuous Thermal Rating: 1.33 at 30 C. amb.;
1.0 at 55 C. amb. Average.

Application: Ammeters and Wattmeters and Relays.
Insulation Class: 0.6 kV. BIL 10kV. full wave 50-400 Hz.
Fully encapsulated.

Standard 5 amp secondary, others available.

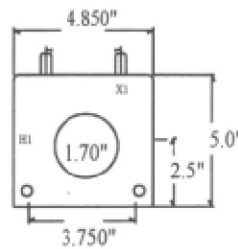
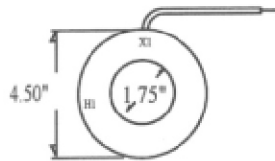
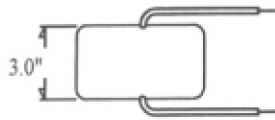

17503RW

17503SH

To order, please complete the model number with the appropriate suffix.
eg. 17503RW-100

- ▶ Flexible leads are UL 3173 125 degree C.
- ▶ CSA approved, # 16 AWG 24" long. Nonstandard length to be specified.
- ▶ Terminals are brass No. 10-32 UNC.
- ▶ Optional mounting bracket 17503MBK.
- ▶ Approximate weight 10.0 lb.
- ▶ Additional ratios available.

Model nbr.	Catalogue nbr. Suffix	Current Ratio	VA for ±1% Class	ANSI Metering Class @ 60Hz				
				BO.1	BO.2	BO.5	BO.9	B1.8
17503RW	-100	100:5	C10	0.6	1.2	2.4	2.4	-
17503SH	-150	150:5	C10	0.3	0.6	1.2	1.2	2.4
	-200	200:5	C20	0.3	0.3	0.6	1.2	2.4
	-250	250:5	C20	0.3	0.3	0.3	0.6	1.2
	-300	300:5	C20	0.3	0.3	0.3	0.6	1.2
	-400	400:5	C50	0.3	0.3	0.3	0.3	0.6
	-500	500:5	C50	0.3	0.3	0.3	0.3	0.3
	-600	600:5	C50	0.3	0.3	0.3	0.3	0.3
	-750	750:5	C50	0.3	0.3	0.3	0.3	0.3
	-800	800:5	C50	0.3	0.3	0.3	0.3	0.3
	-1000	1000:5	C100	0.3	0.3	0.3	0.3	0.3
	-1200	1200:5	C100	0.3	0.3	0.3	0.3	0.3
	-1500	1500:5	C100	0.3	0.3	0.3	0.3	0.3
	-1600	1600:5	C50	0.3	0.3	0.3	0.3	0.3
	-2000	2000:5	C50	0.3	0.3	0.3	0.3	0.3